

mini FLOWATCH® 2

SICCOM

Mini solenoid pump reliable and silent for the condensate removal of air conditioners up to 10 kW / 36 000 BTU / 2.8 RT.

Ref 110-120V: DE05LUB100
Ref 220-240V: DE05LUB110



PREMIUM



**ETL
version**

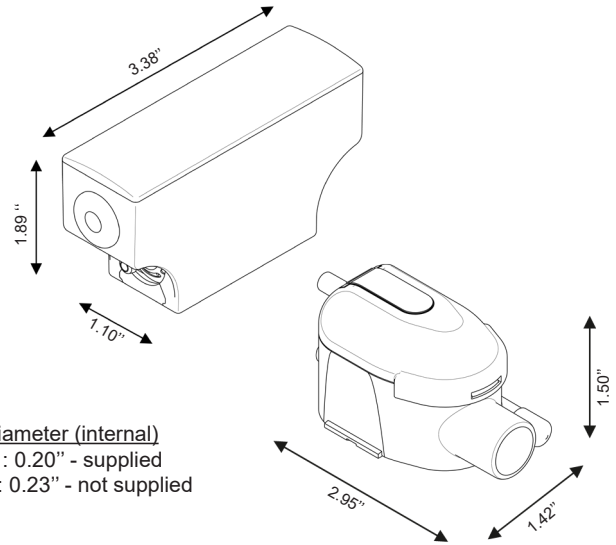

SPECIFICATIONS

Flowrate max	4 gal/h - 15 l/h	
Suction head max	6.5 ft - 2 m	
Discharge head	33 ft - 10 m	
Electrical power	19W	
Voltage	DE05LUB100 DE05LUB110	110-120V 60Hz 220-240V 50/60Hz
Alarm	NO-NC	
Noise level		
Protection rating	IP64	
Thermal protection	Yes	
Operating cycle*	70%	
Power / alarm cable	5.2 ft - 1.8 m	
Dimensions	3.38" x 1.10" x 1.89" / 2.95" x 1.50" x 1.42"	
Certifications	ETL, CE	

* The pump is able to run 70% of the time if necessary (ex 7s ON / 3s OFF).

FLOWRATE

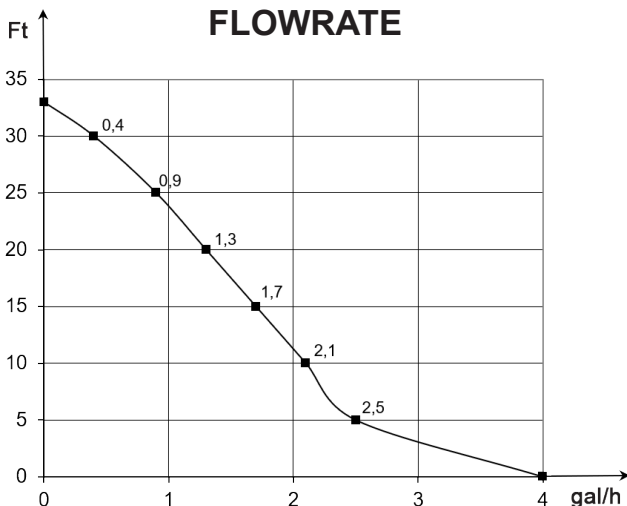

BENEFITS



Very silent

Very silent pump (20.2 dBA), suitable for an installation in any room.



IP64 protection

Protected against water splashes and dust.



Quick connectors

Make installation and maintenance easier.



Clear reservoir

Facilitates maintenance thanks to a quick visualization of the reservoir state.



Metal pump outlets

High solidity and reliability.



Accessories included

All accessories required for installation are included in the box.

Recommended accessory

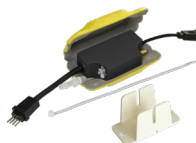

Kit COMFORT

Thanks to its patented foam casing, this kit reduces the noise level and makes the pump easier to install.
Ref: GC077G1027



CONTENTS

Pump - Reservoir with air-vent tube -
Power / alarm cable - Reservoir stand -
Double-side adhesive - Inlet tube -
Suction tube 5.9 ft - 1 clamp